

DEAR PARTNERS,

We would like to extend a wholeheartedly warm greeting to you. The Trade Expo Indonesia (TEI) is here one more time to follow the previous Expo which has successfully attracted 1.550 exhibitors and **14.345** visitors worldwide. This year the Indonesia's largest B2B exhibition is extremely special since it celebrates the **30th** anniversary as a trade show which has been organized by the Ministry of Trade of the Republic of Indonesia, and it keeps moving forward to fuel the movement in the ASEAN Economic Community Era.

In cooperation with Ministry of Foreign Affairs, Ministry of Industry, Ministry of Agriculture, State Ministry of Cooperatives, Small and Medium Enterprises and Indonesia Investment Coordinating Board, this Expo is aimed to promote quality **"Made-in-Indonesia"** products and services to global market, to better develop business and investment networking, and to enhance potentials and opportunities particularly for those seeking business ventures and invest in Indonesia's manufacturing sector.

Since starting this journey, we intend to be the engine of growth not only in Indonesia but also in the region and in the global stage. Yet we know that it will not do any good for us to make these efforts in isolation. It is an Indonesia that grows together with the world that can best work towards these goals. Indeed, we will succeed by working together with our global partners with whom we share a growth vision, and most of all, a dream of bright future.

In this **30** year of TEI's existence we are poised to celebrate our business friendship and the chapter we have lived together. We have a **30** year story that has bound Indonesia and the world together: a story of innumerable business efforts and achievements. And we ask you to join us in making this year's Expo as a trade show of profound celebration.

Now let us rejoice the long road Indonesia and the world have walked down these **30** years and envision the glittering business future that this Expo will help offering.

Expand Your Business Opportunities Tomorrow and Beyond, and Source at Remarkable Indonesia

TEI 2015 will feature 5 (five) product zones and 1 (one) ASEAN Pavilion in honour of ASEAN Economic Community era. The zones are **Manufactured Goods and Services; Furniture & Furnishings; Food & Beverages; Fashion, Lifestyle and Creative Products; and Premium SME's Products from Indonesia's Provinces.**

GENERAL INFORMATION

All visitors to Indonesia must be in possession of a valid passport for at least six months from the date of arrival for certain countries and must be checked for current regulations prior to departure. Call our Indonesian Embassy or Consulate for up-to-date information or log on to www.imigrasi.go.id. Most business visitors will be welcomed at Jakarta's Soekarno-Hatta Airport by Directorate General of National Export Development (DGNED) staffs. Trade Expo Indonesia 2015 will also have a reception/information desk at Soekarno-Hatta International Airport to guide all official delegates to their hotel pick-up service.



BUSINESS CENTER

Located near the registration desk in every Hall with secretarial services, computers, fax, and internet connection.

VISITING HOURS

Business Visitors

Wednesday - Friday,
21 - 23 October 2015
10 am - 7 pm

Public Visitors

Saturday - Sunday
24 - 25 October 2015
10 am - 7 pm

ATTENDANCE

TEI 2015 is a B2B exhibition and open to professionals and International trade visitors.

VISITORS

10.000 VISITORS

EXHIBITORS

2.000 EXHIBITORS



REASONS TO VISIT

- 1 Trade Expo Indonesia is Indonesia's largest B2B exhibition which offers one-stop-shop for your sourcing of multi products
- 2 Displays more than 200 products and services, divided in 5 large product zones for your comfort
- 3 Presents strong industrial conferences, one-on-one business matching and business clinic to better explore business and investment opportunities
- 4 Offers business potential to expand your business in Indonesia in order to fully capitalize on Asian Economic Community integration
- 5 Provides excellent networking experience as this Expo gives you an opportunity to meet top government officials and key players in the industry

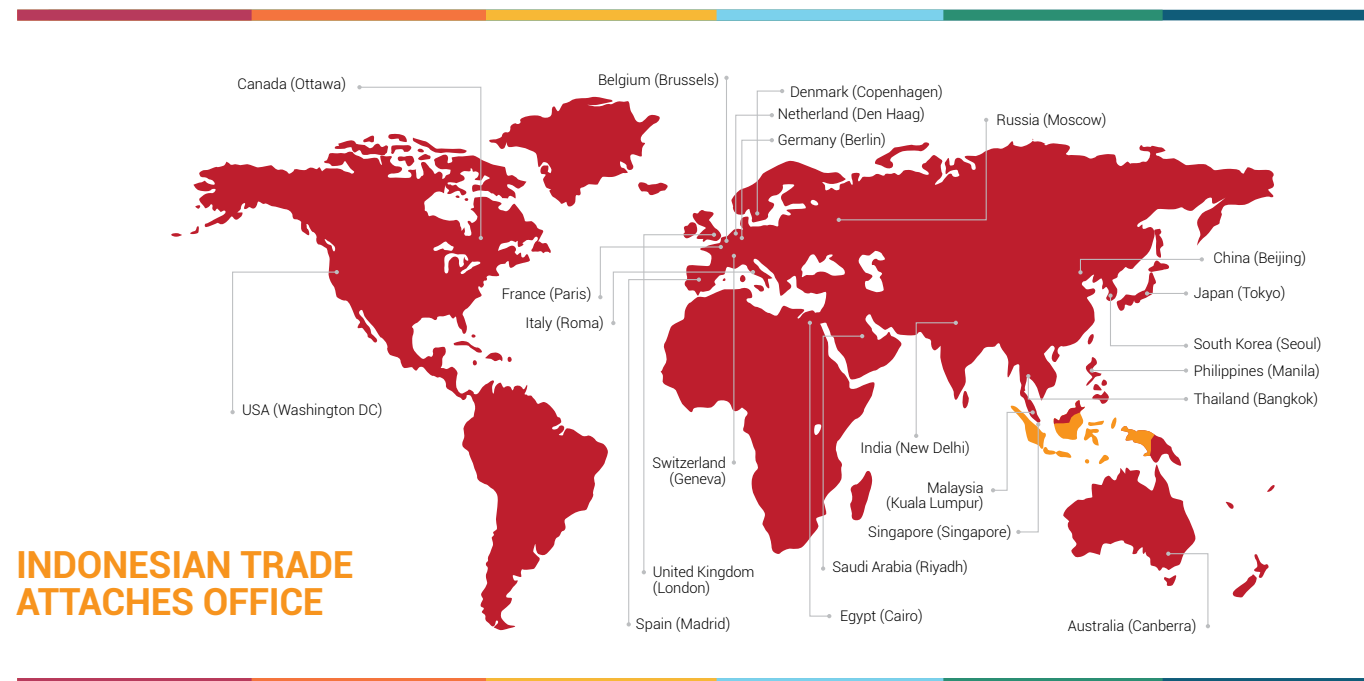

INDONESIAN TRADE ATTACHES OFFICE

Indonesian Trade Promotion Center (ITPC)

Australia (Sydney), Brazil (Sao Paulo), Canada (Vancouver), Chile (Santiago), France (Lyon), Germany (Hamburg), Hungary (Budapest), India (Chennai), Italy (Milan), Japan (Osaka), Mexico (Mexico City), Nigeria (Lagos), Saudi Arabia (Jeddah), South Africa (Johannesburg), South Korea (Bussan), Spain (Barcelona), United Arab Emirate (Dubai), USA (Los Angeles and Chicago)

Indonesian Economic and Trade Office

Taiwan (Taipei)

Indonesian Trade Consul

Hong Kong

or visit

www.tradexpoindonesia.com
for details

for buyer information:

Phone. +62 21 3510 347/2352 8645

Fax. +62 21 2352 8645

Email - tradexpoindonesia@kemendag.go.id



@tradexpind

Trade EXpo Indonesia

Supported by:



trade with
**remarkable
Indonesia**



Exhibition | Trade & Investment | Business Forum | Business Matching

PREVIOUS TRADE EXPO INDONESIA IN FIGURE

THE 10th LARGEST PRODUCTS IN TRANSACTION



THE 5th LARGEST FOREIGN BUYERS TRANSACTION

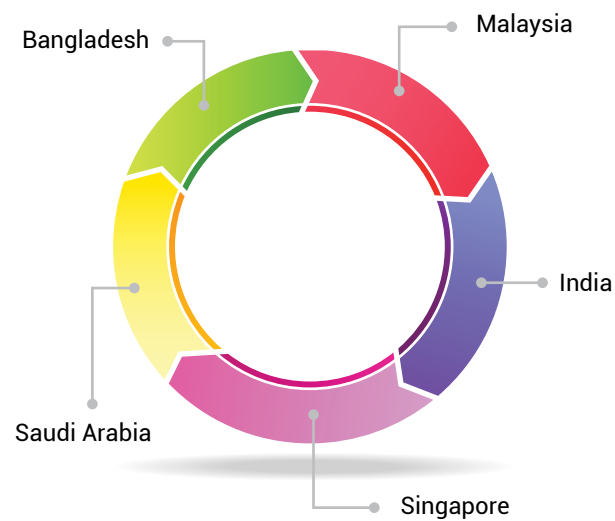

ADMISSION

Admission is **FREE** but Pre-registration is recommended
Visitor Pre-registration will be available online on www.tradexpoindonesia.com
Walk-in visitors are able to directly register at the venue in registration counters*
Trade Mission Badges will be given out upon registration at registration counter*
Pre-registered visitors are able to collect their badges at the registration counters* (please show the printout confirmed registration)
Submission and approval of visa through Indonesian Embassy/Consulate General Office (please show the print out confirmed registration and your company profile)

*starting from 21 October 2015

MAJOR PROGRAMS

Trade and Investment Forum
Investment Exhibition
Business and Investment Clinic
Company Visit*
One-on-one Business Matching*

*terms & conditions apply and early register before August 31st



PRODUCTS & SERVICES OF INTEREST



Product Inquiry?
Phone. +62 21 3510 347
Fax. +62 21 2352 8652
Email. csc@kemendag.go.id

BUYER'S BENEFITS

- Free 2 (two) nights complimentary accommodation during the trade show period*
- Free airport pickup to hotel upon arrival*
- Shuttle Services Hotel - Venue - Hotel*
- Complimentary use of business lounge at venue
- Free Wi-Fi at venue

* Please contact Indonesia representative office (Indonesian Embassy, Indonesia Consulate General, Indonesia Trade Promotion Office (ITPC / IETC in Taiwan) to get this benefit and early register before August 2015

VISITOR PROFILE

TEI 2015 is a must-visit for:

- Manufacturers
- Importers
- Distributors and Wholesalers
- Retailers
- Hoteliers and Restaurateurs
- Investors
- Business and Trade Associations
- Agents
- Media

VENUE

JiExpo is located on a 44 hectare-land, at the heart of the capital city of Indonesia. Considering its strategic location, it has become the number one choice of local and foreign exhibitors from various businesses to exhibit their products and services there.

Visitors coming from other cities by planes arriving at the Soekarno-Hatta International Airport can take a taxi to Jakarta International Expo (fairground). Approximately take around 1.5 hours.

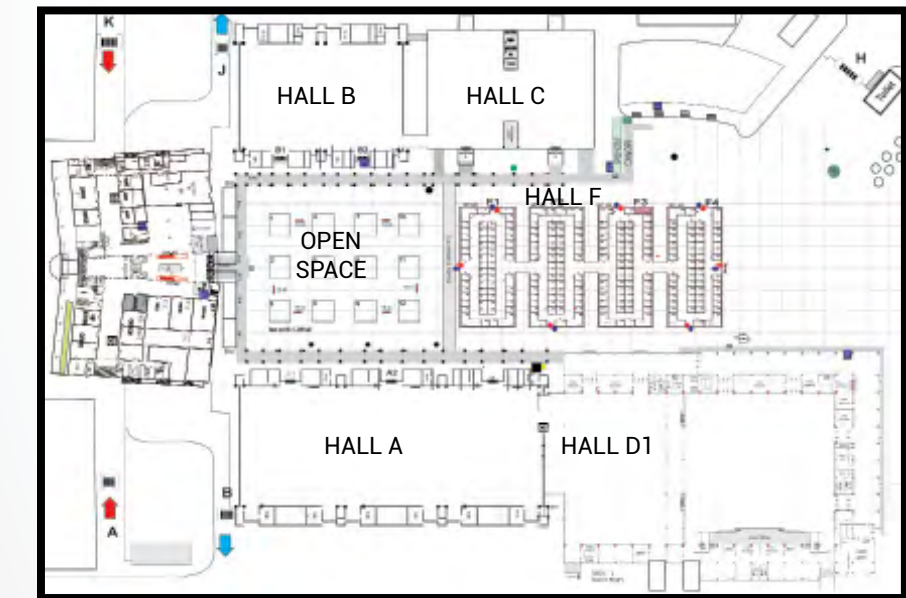

HALL C

Processed Food and Beverages, Fishery Products, Agricultural Products

HALL D1

Premium Fashion, Lifestyle and Creative Products

- Fashion & Accessories
- Jewelry
- Premium Handicraft
- Health & Beauty Products

"Pride of Indonesia" Pavilion
ASEAN Pavilion

HALL F

Premium products of Indonesia's Province

OPEN SPACE

Knock Down House, Garden Furniture, Heavy Equipment, and Solar Panel Showcase

LAYOUT PLAN

HALL A

Manufactured Goods (Automotive and Automotive Components, Electronic and Electrical Appliances, Medical Equipment, Footwear, Textile and Textile Products, Consumer Goods, Household Appliances, Toys, Sporting Goods, Leather and Leather Products, Rubber and Rubber Products, Paper and Paper Products, Building Material) and Services (Business, Construction, ICT, Skilled manpower).

HALL B

Furniture and Home Decoration

OFFICIAL TRAVEL AGENT

The official Travel Agent will help the international buyers with their inbound and outbound itinerary

Time Travel
Plaza Sentral 3rd Floor
Jl Jend. Sudirman Kav. 47 Jakarta

Contact : Crispina Wahyu Dwiriarti
Phone : 0816 830233 / 021 5702356
Fax : 021 5267229
Email : info@timetravel.co.id